

## 10 MAINTENANCE AND CLEANING

The following points have to be considered during the inspection:

- 1) All screws for installing the devices or parts of the device have to be tightly connected and must not be corroded.
- 2) There must not be any deformations on the housing, color lenses, fixations and installation spots (ceiling, suspension, trussing).
- 3) Mechanically moved parts must not show any traces of wearing and must not rotate with unbalances.
- 4) The electric power supply cables must not show any damage, material fatigue or sediments.

Further instructions depending on the installation spot and usage have to be adhered by a skilled installer and any safety problems have to be removed.



### CAUTION

Disconnect from mains before starting maintenance operation.



In order to make the lights in good condition and extend the life time, we suggest a regular cleaning to the lights.

- 1) Clean the inside and outside lens each week to avoid the weakness of the lights due to accumulation of dust.
- 2) Clean the fan each week.
- 3) A detailed electric check by approved electrical engineer each three month, make sure that the circuit contacts are in good condition, prevent the poor contact of circuit from overheating.

We recommend a frequent cleaning of the device. Please use a moist, lint- free cloth. Never use alcohol or solvents.

There are no serviceable parts inside the device. Please refer to the instructions under "Installation instructions".

Should you need any spare parts, please order genuine parts from your local dealer.



**ADD** 3rd Floor, No. 288, Guangzhu East Line, Pingwen, Lanhe Town, Nansha District, Guangzhou, China

**Tel.** +86 20 8499 2310/2320/2330

**Fax** +86 20 8499 2360

**E-mail** info@color-imagination.com

**Website** www.color-imagination.com

**Follow  
us on**



[www.facebook.com/color.imagination.1](http://www.facebook.com/color.imagination.1)



[www.youtube.com/user/colorimaginationj](http://www.youtube.com/user/colorimaginationj)



[twitter.com/colorimaginej](http://twitter.com/colorimaginej)

**Color**<sup>®</sup>  
IMAGINATION  
the POWER of DREAM

# SI-080 COLORAY 120F

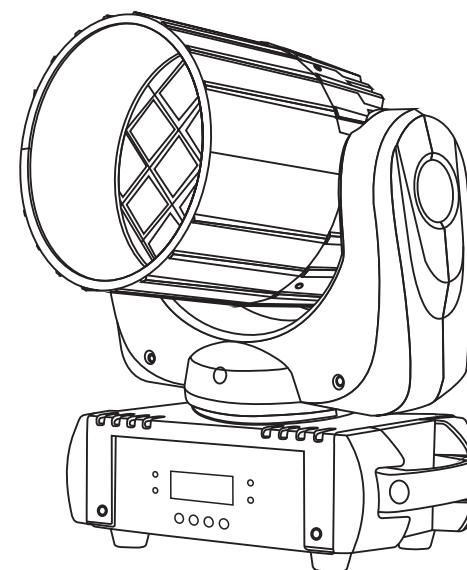

WIFI White Case CE F IP20 LED 0.2m t<sub>a</sub> 40°C t<sub>c</sub> 150°C

# User Manual

KEEP THIS MANUAL FOR FUTURE NEEDS

## 1 SAFETY INSTRUCTIONS



### CAUTION

Becareful with your operations. With a dangerous voltage you cansuffer a dangerous electric shock when touching wires!

This device has left the factory in perfect condition. In order to maintain this condition and to ensure a safe operation, it is absolutely necessary for the user to follow the safety instructions and warning notes written in this user manual.



### IMPORTANT

Damages caused by the disregard of this user manual are not subject to warranty. The dealer will not accept liability for any resulting defects or problems.

If the device has been exposed to temperature changes due to environmental changes, do not switch it on immediately. The arising condensation could damage the device. Leave the device switched off until it has reached room temperature.

This device falls under protection-class I. Therefore it is essential that the device be earthed.

The electric connection must carry out by qualified person.

The device shall only be used with rate voltage and frequency.

Make sure that the available voltage is not higher than stated at the end of this manual.

Make sure the power cord is never crimped or damaged by sharp edges. If this would be the case, replacement of the cable must be done by an authorized dealer.

Always disconnect from the mains, when the device is not in use or before cleaning it. Only handle the power cord by the plug. Never pull out the plug by tugging the power cord.

During initial start-up some smoke or smell may arise. This is a normal process and does not necessarily mean that the device is defective, it should decrease gradually.

Please don't project the beam onto combustible substances.

Fixtures cannot be installed on combustible substances, keep more than 50cm distance with wall for smooth air flow, so there should be no shelter for fans and ventilation for heat radiation.

If the external flexible cable or cord of this luminaire is damaged, it shall be exclusively replaced by the manufacturer or his service agent or a similar qualified person in order to avoid a hazard.

## 2 UNPACKING

Thank you for choosing Color Imagination's COLORAY 120F. For your own safety, please read this manual before installing the device. This manual covers the important information on installation and applications. Please install and operate the fixture with following instructions. Meanwhile, please keep this manual well for future needs.

Color Imagination's COLORAY 120F is made of a new type of high temperature strength of engineering plastics and cast aluminum casing with nice outlook. The fixture is designed and manufactured strictly following CE standards, complying with international standard DMX512 protocol. It's available independently controlled and linkable with each other for operation. And it is applicable for large-scale live performances, theater, studio, nightclubs and discos.

SI-080 adopts 12PCS CREE XLamp MC-E 10W 4-IN-1 LEDs which features high brightness and stability. Please carefully unpack it when you receive the fixture and check whether it is damaged during the transportation. And please check whether the following items are included inside the box:

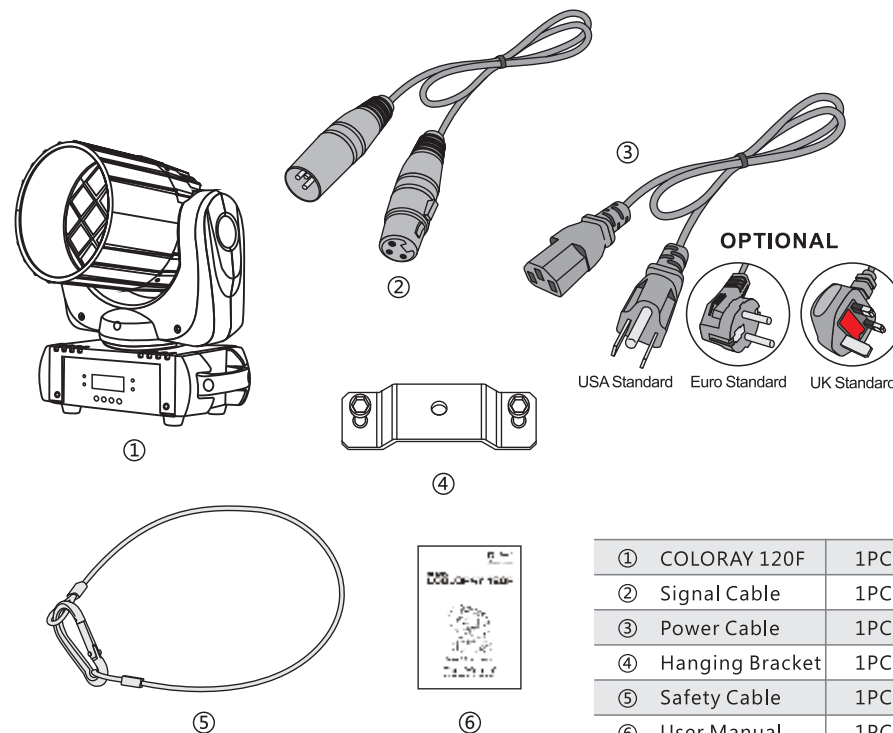

①	COLORAY 120F	1PC
②	Signal Cable	1PC
③	Power Cable	1PC
④	Hanging Bracket	1PC
⑤	Safety Cable	1PC
⑥	User Manual	1PC

### 3 FEATURES & SPECIFICATIONS

#### Features

- 12PCS CREE XLamp MC-E 10W 4-IN-1 LEDs
- 50000 hours lifespan and lower power consumption
- Each color controllable
- Punching multi ray beam effect, 0-30° clockwise or anticlockwise rotation
- Cohesive beam effect when it stops at 0°
- Special running effect in unlimited rotation for the optic
- Specific optic system driven by a unlimited motor
- Very fast, smooth, quiet and precise PAN/TILT movement
- 540° PAN movement and 200° TILT movement
- Scan position memory, auto reposition after unexpected movement
- High efficiency LED shutter and strobe effect (1-20T/S)
- Pulse strobe effect and random strobe effect available
- 0-100% Smooth linear LED dimmer
- Macro effect (patterns and beams)
- 18 DMX channels USITT DMX-512
- DMX 512, master-slave, sound activated or auto operation
- Greend LCD display
- 3Efficient lower noise fan cooling system
- Powercon IN/OUT
- 3-Pin XLR connectors IN/OUT
- Compactsize with 5.2KG body and 380 in height
- -45°C min and 45°C max ambient temperature
- IP20 protection rating
- High tension safe installation kits

#### Specifications

<b>Input Voltage:</b>	AC90-260V 50/60Hz
<b>LED Quantities:</b>	12PCS CREE XLamp MC-E 10W 4-IN-1 LEDs
<b>Control Signal:</b>	DMX512, master-slave and sound activated or auto operation
<b>Control Channel:</b>	18 DMX channels USITT DMX-512
<b>Power Consumption:</b>	155W
<b>Dimensions:</b>	318(D)*411(W)*628(H)mm
<b>Packing Dimensions:</b>	152(D)*265(W)*380(H)mm
<b>Net Weight:</b>	5.3kg
<b>Gross Weight:</b>	6.3kg

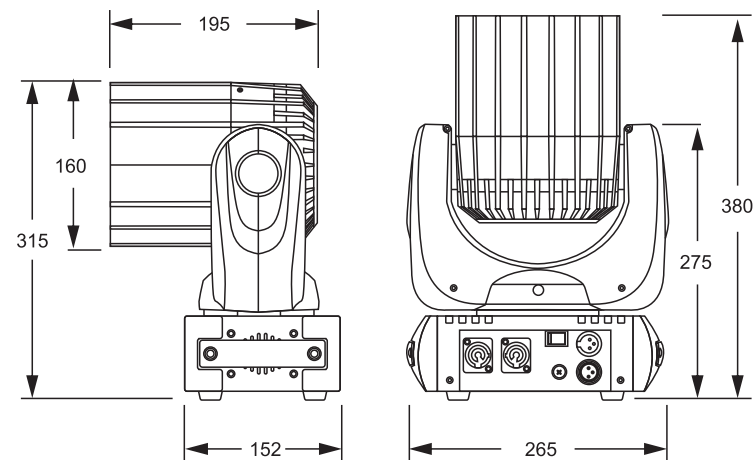

### 4 OPERATION INSTRUCTIONS

- The moving head is for beam effect for on-site decoration purpose.
- Don't turn on the fixture if it's been through severe temperature difference like after transportation because it might damage the light due to the environment changes. So make sure to operate the fixture until it is in normal temperature.
- This light should be keep away from strong shaking during any transportation or movement.
- Don't pull up the light by only the head, or it might cause damages to the mechanical parts.
- Don't expose the fixture in overheat, moisture or environment with too much dust when installing it. And don't lay any power cables on the floor. Or it might cause electronic shock to the people.
- Make sure the installation place is in good safety condition before installing the fixture.
- Make sure to put the safety chain and check whether the screws are screwed properly when installing the fixture.
- Make sure the lens are in good condition. It's recommended to replace the units if there are any damages or severe scratch.
- Make sure the fixture is operated by qualified personnel who knows the fixture before using.
- Keep the original packages if any second shipment is needed.

- Don't try to change the fixtures without any instruction by the manufacturer or the appointed repairing agencies.
- It is not in warranty range if there are any malfunctions from not following the user manual to operate or any illegal operation, like shock short circuit, electronic shock, lamp broke, etc.

## 5 INSTALLATIONS

**Cautions:** For added protection mount the fixtures in areas outside walking paths, seating areas, or in areas where the fixture might be reached by unauthorized personnel.

Before mounting the fixture to any surface, make sure that the installation area can hold a minimum point load of 10 times the device's weight.

Fixture installation must always be secured with a secondary safety attachment, such as an appropriate safety cable.

Never stand directly below the device when mounting, removing, or servicing the fixture.

from a ceiling, or set on a flat level surface (see illustration below). Be sure this fixture is kept at least 0.5m (1.5 ft) away from any flammable materials (decoration etc.).

Always use and install the supplied safety cable as a safety measure to prevent accidental damage and/or injury in the event the clamp fails.

**Mounting points:** Overhead mounting requires extensive experience, including amongst others calculating working load limits, a fine knowledge of the installation material being used, and periodic safety inspection of all installation material and the fixture. If you lack these qualifications, do not attempt the installation yourself. Improper installation can result in bodily injury.

Be sure to complete all rigging and installation procedures before connecting the main power cord to the appropriate wall outlet.

**Clamp Mounting:** The COLORAY 120F provides a unique mounting bracket assembly that integrates the bottom of the base, the included "Hanging Bracket," and the safety cable rigging point in one unit (see the illustration below). When mounting this fixture to truss be sure to secure an appropriately rated clamp to the included omega bracket using a M10 screw fitted through the center hole of the "Hanging Bracket". As an added safety measure be sure to attach at least one properly rated safety cable to the fixture using one of the safety cable rigging points integrated in the base assembly.

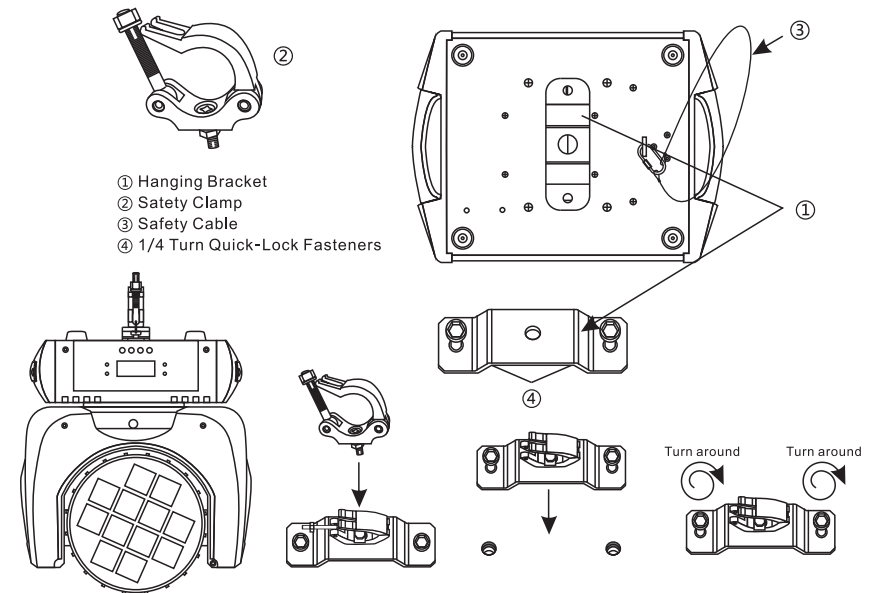

Regardless of the rigging option you choose for your COLORAY 120F, always be sure to secure your fixture with a safety cable. The fixture provides a built-in rigging point for a safety cable on the hanging bracket as illustrated above. Be sure to only use the designated rigging point for the safety cable and never secure a safety cable to a carrying handle.

## 6 DMX-512 CONTROL CONNECTIONS

Connect the provided XLR cable to the female 3-pin XLR output of your controller and the other side to the male 3-pin XLR input of the moving head. You can chain multiple

Moving head together through serial linking. The cable needed should be two core, screened cable with XLR input and output connectors. Please refer to the diagram below.

DMX-512 connection with DMX terminator

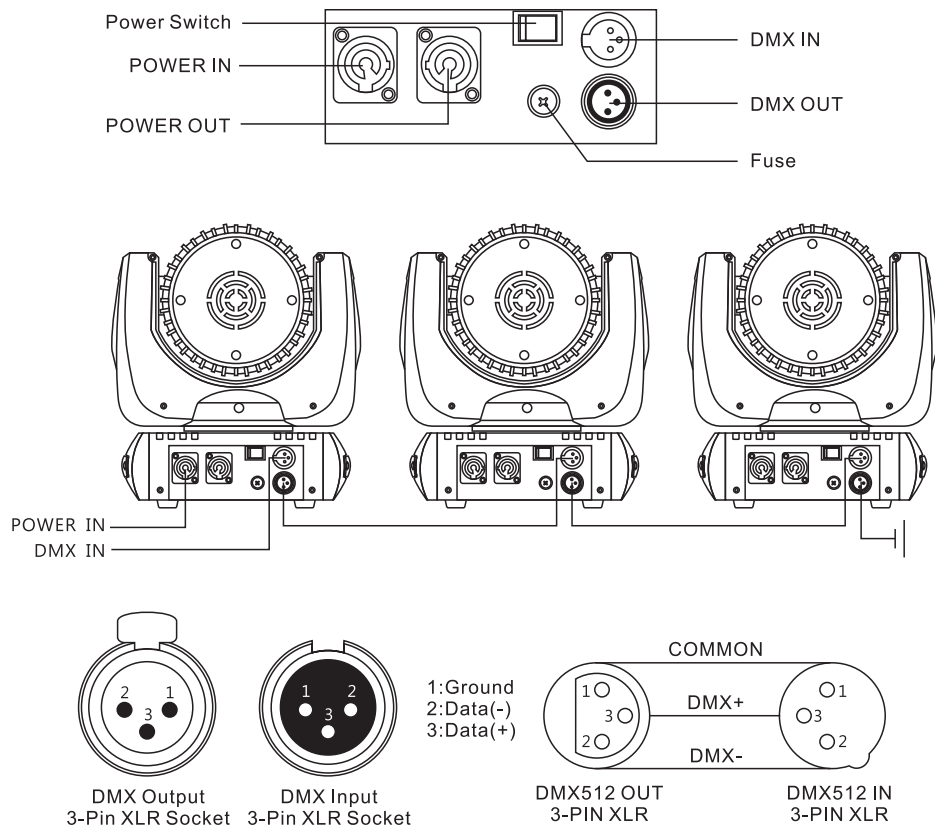

For installations where the DMX cable has to run a long distance or is in an electrically noisy environment, such as in a discotheque, it is recommended to use a DMX terminator. This helps in preventing corruption of the digital control signal by electrical noise. The DMX terminator is simply an XLR plug with a 120  $\Omega$  resistor connected between pins 2 and 3, which is then plugged into the output XLR socket of the last fixture in the chain. Please see illustrations below.

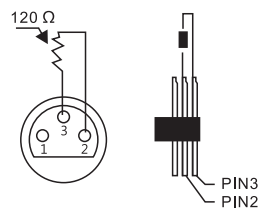

## 7 MENU OPERATIONS

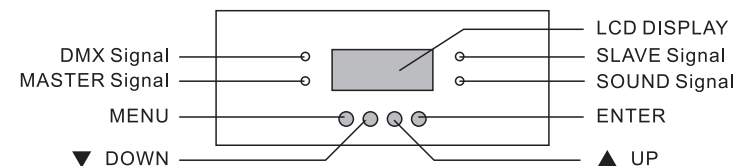
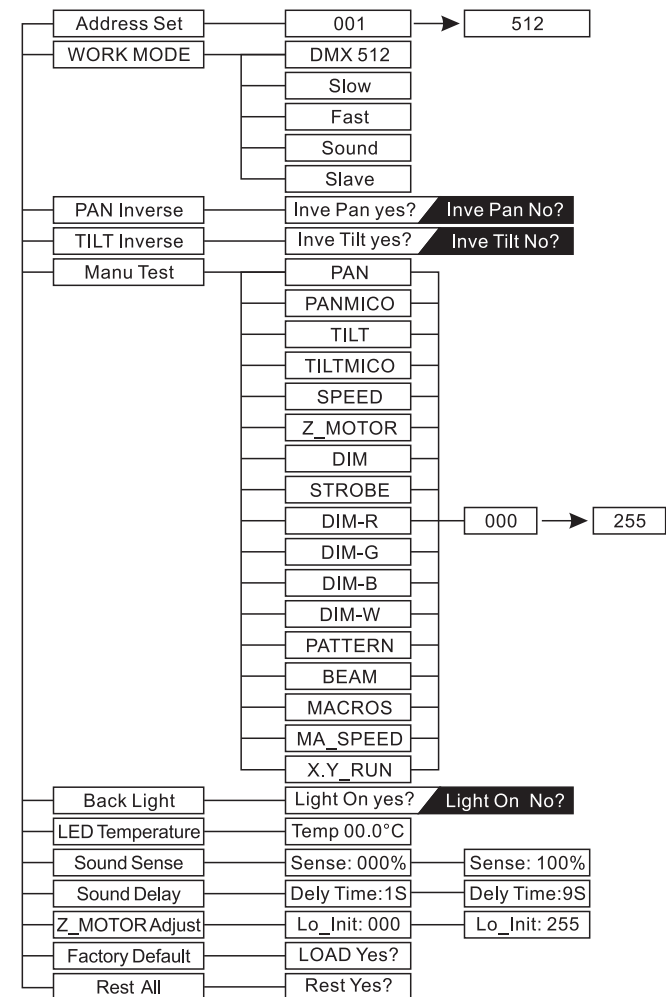

## 8 DMX CHANNELS

Channel	Function	Value	Description
1	Pan	0-255	PAN Movement
2	Pan Fine	0-255	Fine control of Pan movement
3	Tilt	0-255	Tilt Movement
4	Tilt Fine	0-255	Fine control of Tilt movement
5	Speed	0-255	Speed control of PAN/TILT movement from fast to slow
6	LED Panel Rotation	0-004	Cohesive beam effect
		005-105	0-30° Anticlockwise rotation
		106-205	0-30° Clockwise rotation
		206-255	Unlimited rotation from slow to fast
7	Dimmer	0-255	0-100% Linear dimmer
8	Strobe	0-003	No function
		004-095	Strobe effect from slow to fast (1-25Hz)
		096-176	Random strobe effect
		177-255	Pulse strobe effect
9	Red	0-255	0-100% Linear red dimmer
10	Green	0-255	0-100% Linear green dimmer
11	Blue	0-255	0-100% Linear blue dimmer
12	White	0-255	0-100% Linear white dimmer
13	Patterns	0-009	No function
		010-019	Red for all 4 sections
		020-029	Green for all 4 sections
		030-039	Blue for all 4 sections
		040-049	White for all 4 sections
		050-059	C for all 4 sections
		060-069	RW combination
		070-079	BG combination
		080-089	CG combination
		090-099	WG combination
		100-109	BR combination
		110-119	WY combination
		120-129	BC combination
		130-139	BW combination
		140-149	WC combination
		150-159	BRW combination
		160-169	BGW combination
		170-179	Single color chasing
		180-189	Two colors chasing
		190-199	RGB combination
		200-209	BGW combination

14	Beam, Rainbow	210-219	RBW combination
		220-229	RB-W flashing in sequence
		230-239	B-GW flashing in sequence
		240-249	R-GB flashing in sequence
		250-255	RW-GW-BW-RGW changing in sequence
		0-009	No function
		010-019	Mini beam effect in blue
		020-029	Mini beam effect in white
		030-039	Mini beam effect in red
		040-049	Mini beam effect in green
		050-059	Mini beam effect in red and white
		060-069	Mini beam effect in green and white
		070-079	Mini beam effect in blue and white
		080-089	Mini beam effect in red and blue
		090-099	Rainbow effect in up direction
		100-109	Rainbow effect in down direction
		110-119	Rainbow effect in left direction
		120-129	Rainbow effect in right direction
		130-139	Medium beam effect in red+blue with some white
		140-149	Medium beam effect in red+green
		150-159	Medium beam effect in blue+green with some white
15	Macro	160-169	Medium beam effect in red+green+blue+white
		170-179	Medium beam effect in red+white
		180-189	Medium beam effect in blue+green
		190-199	Large beam effect in blue+red+white
		200-209	Large beam effect in blue+green+white
16	Speed	210-219	Large beam effect in blue+white
		220-229	Large beam effect in red+white
		230-239	Large beam effect in blue+green
		240-249	Large beam effect in green+white
		250-255	Large beam effect in red+blue
17	PAN/TILT Auto	0-049	CH1-CH12 valid
		050-099	Patterns display (used with CH13)
		100-149	Beams display (used with CH14)
		150-199	Colors from dark to bright and colors from bright to dark
		200-255	Music control
18	Reset	0-255	Speed control of macro
		0-049	PAN/TILT movement by controller
		050-099	PAN/TILT movement in slow speed
		100-149	PAN/TILT movement in fast speed
		150-199	PAN/TILT movement in slow speed and fast speed
		200-255	PAN/TILT movement by music control
		0-250	No function
		251-255	Reset in 6 seconds